

Components for safety applications

Limit switches

Metal, painted red, turret head, type XCL-J

Cable entry tapped M20 x 1.5

References, characteristics

Type of operating head	Plunger	Rotary
------------------------	---------	--------

Available for UK market only

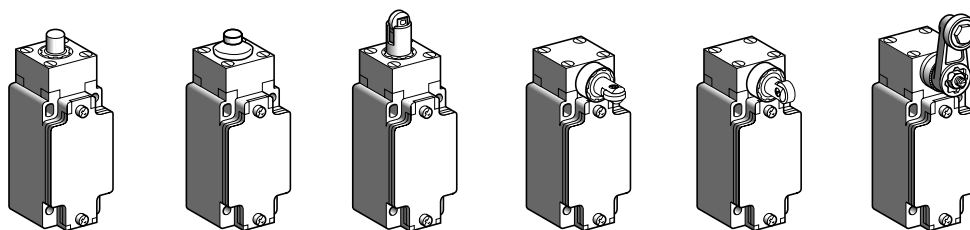

Type of operator	Steel end plunger	Steel end plunger with rubber boot	Steel roller plunger	Side plunger with horizontal roller	Side plunger with vertical roller	Thermoplastic roller lever (1)
------------------	-------------------	------------------------------------	----------------------	-------------------------------------	-----------------------------------	--------------------------------

(1) Adjustable throughout 360° in 5° steps or in 45° steps by reversing the lever mounting or clamp. Switch supplied for actuation from left AND right.

References (☉ N/C contact with positive opening operation)

2-pole 1 N/C + 1 N/O break before make, slow break (XEN-P2151)		XCL-J561H29 ☉	XCL-J5619H29 ☉	XCL-J567H29 ☉	XCL-J564H29 ☉	XCL-J565H29 ☉	XCL-J50511H29 ☉
2-pole 2 N/C simultaneous, slow break (XEN-P2141)		XCL-J761H29 ☉	XCL-J7619H29 ☉	XCL-J767H29 ☉	XCL-J764H29 ☉	XCL-J765H29 ☉	XCL-J70511H29 ☉
Weight (kg)		0.430	0.430	0.445	0.495	0.495	0.480

Characteristics

Conforming to standards	Products	IEC 947-5-1, IEC 337-1, EN 60 947-5-1, NF C63-140, VDE 0660-200					
	Installation	IEC 204-1, EN 60 204-1, NF C 79-130					
Protective treatment	Standard version : "TH"						
Ambient air temperature	Operation : - 25...+ 70 °C. Storage : - 40...+ 70 °C						
Vibration resistance	25 g (10...500 Hz) conforming to IEC 68-2-6						
Shock resistance	50 g conforming to IEC 68-2-27						
Electric shock protection	Class I conforming to IEC 536 and NF C20-030						
Degree of protection	IP 66 conforming to IEC 529 ; IP 667 conforming to NF C 20-010						
Mechanical durability (op. cycles)	30 million		25 million		30 million		
	Minimum force for tripping	18 N	14 N			0.25 N.m	
or torque for positive opening	35 N	28 N			0.35 N.m		
Maximum actuation speed	0.5 m/s		1 m/s		0.6 m/s		
	Switch actuation	On end	By 30° cam				
Repeat accuracy	0.01 mm on the tripping points						
Rated operational characteristics	\sim AC15 ; A 300 or $U_e = 240$ V, $I_e = 3$ A --- DC13 ; Q 300 or $U_e = 250$ V, $I_e = 0.27$ A conforming to IEC 947-5-1 Appendix A, EN 60 947-5-1						
Rated insulation voltage	$U_i = 500$ V degree of pollution 3 conforming to IEC 947-1, group C conforming to NF C 20-040 and VDE 0110						
Rated impulse withstand voltage	$U_{imp} = 6$ kV conforming to IEC 947-1, IEC 664						
Positive operation	N/C contact with positive opening operation conforming to IEC 947-5-1 Section 3, EN 60 947-5-1						
Resistance across terminals	≤ 25 m Ω conforming to NF C 93-050 method A or IEC 255-7 category 3						
Short-circuit protection	10 A cartridge fuse type gG (gl) conforming to IEC 947-5-1, VDE 0660-200						
Cable entry	1 entry, tapped 20 mm ISO						
Cabling	Screw and captive cable clamp terminals. Capacity : min. 1 x 0.34 mm ² , max. 2 x 2.5 mm ² depending on contact.						

Components for safety applications

Limit switches
Metal, painted red, turret head, type XCL-J

Setting-up, dimensions

Available for UK market only

Setting-up

Cam displacement

XCL-J67H29

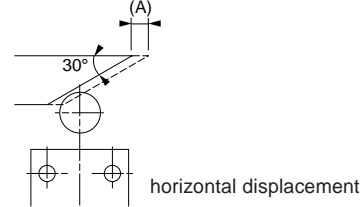

Function diagrams

XCL-J561H29, J5619H29

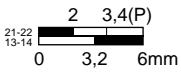

XCL-J567H29

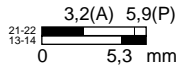

XCL-J564H29, J565H29

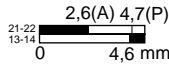

XCL-J50511H29

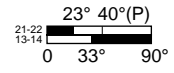

XCL-J761H29, J7619H29

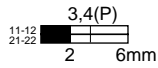

XCL-J767H29

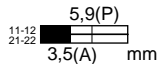

XCL-J764H29, J765H29

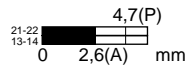

XCL-J70511H29

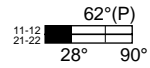

Contact operation : contact closed, contact open

(A) = cam displacement (P) = positive opening point

Dimensions

XCL-J561H29, J761H29

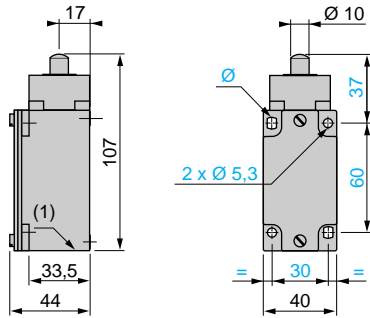

XCL-J5619H29, J7619H29

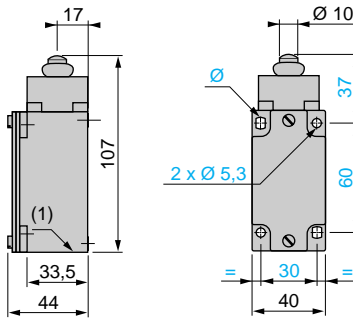

XCL-J567H29, J767H29

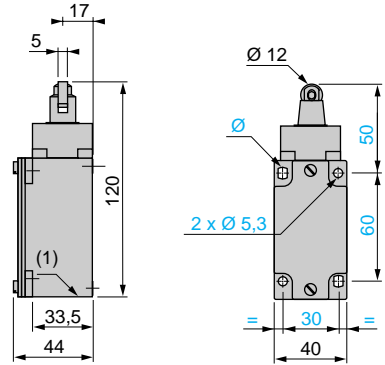

XCL-J564H29, J764H29

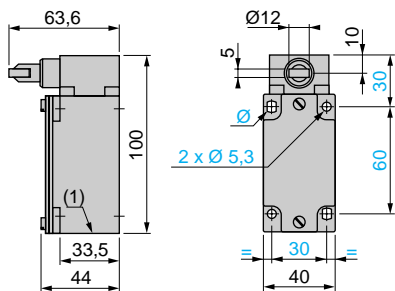

XCL-J565H29, J765H29

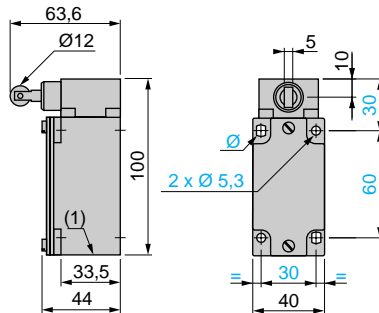

XCL-J50511H29, J70511H29

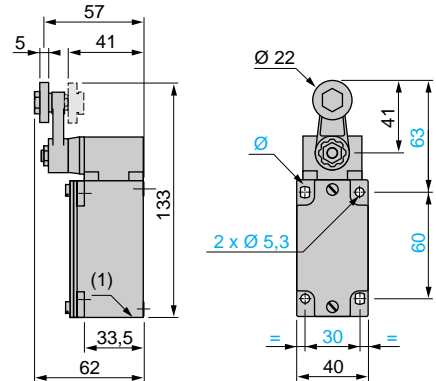

(1) 1 cable entry, tapped 20 mm ISO

Ø : 2 elongated holes Ø 5.3 x 7.3